

CRES-W1352

8.5kg



### Product Information

6-wheel creeper for easy maneuverability. Precision manufactured for quality and performance.

### Product Specs

Adjustable, cushioned headrest for comfort.  
Fully padded bench for back support.  
Heavy-duty tubular steel construction for stability and durability.  
Supports up to 113 kg (250 lbs).  
6 x 360-degree swivel casters for smooth movement.  
Dimensions: 1016 mm L x 426 mm W x 112 mm H.

### Operating Instructions

1. Before each use, carefully inspect the product to ensure it is not damaged, excessively worn, or missing parts.
2. Do not use the product unless it is properly lubricated and in good, clean working condition.
3. Using a product that is not properly maintained may result in serious injury.
4. Inspect the work area to ensure it is free of hazards.

### Safety Information

Before Working on a Vehicle or Using This Product:

1. Always use jack stands to support the vehicle.
2. Do not use wood blocks or any non-approved load-sustaining or lifting devices.
3. Failing to follow these warnings could result in injury or death.

Important Warnings:

1. Study, understand, and follow all instructions before using this device.
2. Do not exceed the rated capacity, which includes the weight of the user, tools, equipment, and any personal items.
3. Only use the device on hard, level surfaces with less than a 3-degree slope.
4. Do not use the creeper as a dolly.
5. Sit down gently—avoid jumping or falling onto the product to prevent shock loads.
6. Do not stand on the product.
7. Be aware of pinch and crush hazards when folding or unfolding the product.
8. Keep out of reach of children. This product is not intended for children's use.
9. Never use the product unless the vehicle is properly secured.
10. Only use attachments and adapters supplied by the manufacturer.
11. Never allow anyone to go under a vehicle being repaired unless the vehicle is properly supported by jack stands.
12. Use wheel chocks or other blocking devices on the opposing wheels when working on a vehicle.
13. Do not alter the product in any way.
14. Only use this product for the manufacturer's intended purpose.
15. Failure to follow these warnings could result in personal injury or property damage.

### Warranty Information

All Wayco Equipment products are covered by a 12-month warranty. In the event of a fault, Wayco Equipment will arrange for the repair or replacement of the product, at its discretion. This warranty will be void if the product is repaired, dismantled, or altered without prior authorization from Wayco Equipment. A valid proof of purchase is required to process any warranty claim.

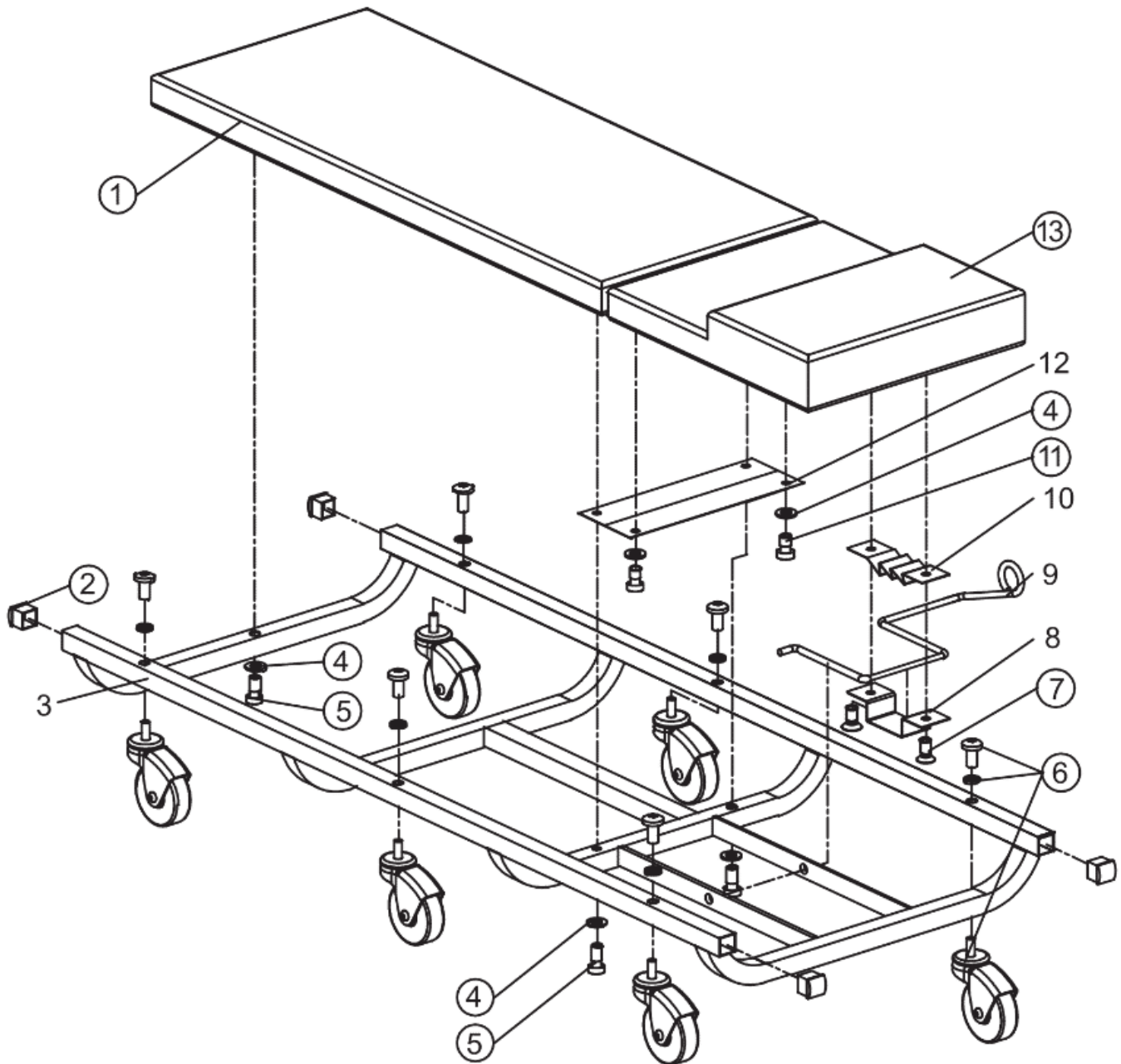

Item	Code	Description	Qty
1		Vinyl Pad #2	1
2		Plastic End Cap	4
3		Metal Frame Base	1
4		Washer M6	5
5		Cross-recess Screw M6x40mm	3
6		Caster Assembly	6
7		Counter-sunk Phillips Machine Screw M6x20mm	2
8		Limiter Plate	1
9		Control Rod	1
10		Headrest Adjuster Plate	1
11		Cross-recess Screw M6x20mm	2
12		Metal Hinge	1
13		Vinyl Pad #1	1

## INSPECTION

- Inspect the product carefully before each use. Ensure the product is not damaged, excessively worn, or missing parts.
- Do not use the product unless it is properly lubricated.
- Using a product that is not in good clean working condition or properly lubricated may cause serious injury.
- Inspect the work area before each use. Make sure it is free and clear of any potential hazards.

## SAFETY

BEFORE PERFORMING ANY WORK ON A VEHICLE OR USING THIS PRODUCT:

Always use Jack Stands!

DO NOT USE wood blocks or any other non-approved load sustaining devices.

DO NOT USE wood blocks or any other non-approved lifting devices for a means of lifting with a jack and or load being raised. Failure to heed these warnings may cause injury or death.

### ▲ WARNING!

1. Study, understand, and follow all instructions before operating this device.
2. Do not exceed rated capacity. (includes user, tools, equipment and personal items).
3. Use only on hard, level surfaces, with less than 3 degrees of slope.
4. Do use as a dolly.
5. Sit down gently! Avoid shock loads caused by jumping or falling onto product.
6. Do not stand on product.
7. Beware of pinch and crush hazards when folding and unfolding.
8. Keep out of the reach of children! This device is not appropriate for children's use.
9. Do not use product unless vehicle is properly secured.
10. Only attachments and/or adapters supplied by the manufacturer shall be used.
11. Do not allow anyone under a vehicle that is being repaired, until the vehicle has been properly supported by jack stands.
12. Use wheel chocks or other blocking devices on opposing wheels before performing work on a vehicle.
13. No alterations shall be made to this product.
14. Do not use this product for any use other than the manufacturer specified usage.
15. Failure to heed these markings may result in personal injury and/or property damage.

## ASSEMBLY INSTRUCTIONS

Safe Operating Temperature is between

40°F – 105°F (4°C - 41°C)

ITEM	DESCRIPTION	Q'TY
1	Vinyl Pad #2	1
2	Plastic End Cap	4
3	Metal Frame Base	1
4	Washer M6	5
5	Cross-recess Screw M6x40mm	3
6	Caster Assembly	6
7	Counter-sunk Phillips Machine Screw M6x20mm	2
8	Limiter Plate	1
9	Control Rod	1
10	Headrest Adjuster Plate	1
11	Cross-recess Screw M6x20mm	2
12	Metal Hinge	1
13	Vinyl Pad #1	1

